

Roller Pump Kits and Accessories

Roller Pump Accessory Selection Guide

Description	Series 1200	Series 1500	Series 1700	Series 6500	Series 7560	Series 7700	Series 4000	Series 5200
540 rpm 1 $\frac{3}{8}$ " Die Cast PTO Adapter	1320-0059	1320-0033	1320-0033	1320-0022	1320-0033	1320-0033	—	1320-0059
540 rpm 1 $\frac{3}{8}$ " Die Cast Quick Coupler	—	1321-0007	1321-0007	1321-0006	1321-0007	1321-0007	—	—
540 rpm 1 $\frac{3}{8}$ " Forged Steel PTO Adapter	1320-0081	1320-0076	1320-0076	1320-0077	1320-0076	1320-0076	—	1320-0081
1000 rpm 1 $\frac{3}{8}$ " Die Cast PTO Adapter	—	1320-0038	1320-0038	1320-0053	1320-0038	—	—	—
1000 rpm 1 $\frac{3}{8}$ " Die Cast Quick Coupler	—	1321-0009	1321-0009	1321-0008	1321-0009	—	—	—
1000 rpm 1 $\frac{3}{8}$ " Forged Steel PTO Adapter	—	1320-0078	1320-0078	1320-0079	1320-0078	—	1320-0079	—
1000 rpm 1 $\frac{3}{8}$ " Forged Steel PTO Adapter	—	1320-0080	1320-0080	—	1320-0080	—	—	—
Multi-Speed 1 $\frac{3}{8}$ " Die Cast Quick Coupler	—	1321-0013	1321-0013	1321-0012	1321-0013	1321-0013	1321-0012	—
540 rpm 1 $\frac{3}{8}$ " Forged Steel Quick Coupler	—	1323-0072	1323-0072	1323-0074	1323-0072	1323-0072	—	—
1000 rpm 1 $\frac{3}{8}$ " Forged Steel Quick Coupler	—	1323-0073	1323-0073	1323-0075	1323-0073	—	—	—
Multi-Speed 1 $\frac{3}{8}$ " Forged Steel Quick Coupler	—	1323-0076	1323-0076	1323-0077	1323-0076	1323-0076	1323-0077	—
Steel Shaft Adapter $\frac{3}{4}$ " x $\frac{5}{8}$ "	—	—	—	1320-0015	—	—	1320-0015	—
Steel Shaft Adapter $\frac{5}{8}$ " x $\frac{5}{8}$ "	—	—	—	1320-0016	—	—	1320-0016	—
Die Cast Coupler $\frac{3}{4}$ " x 1 $\frac{1}{2}$ "	—	1320-0054	1320-0054	—	1320-0054	1320-0054	—	—
Repair Kits	3430-0374	3430-0387 3430-0386	3430-0437	3430-0380	3430-0381	3430-0384	3430-0390	—
Torque Arm Kit	—	—	3430-0540	3430-0540	3430-0540	3430-0540	—	—
Base Kits	—	3420-0004	3420-0010	3420-0023	3420-0003	3420-0010	3420-0024* 3420-0025**	—
Locking Collar Kit	3430-0207	—	—	—	—	—	—	—
Hydraulic Flange Kit	—	—	—	—	3430-0636	—	—	—

* For electric motor drive 3 $\frac{1}{2}$ " shaft centerline (4001, 4101).

** For gas engine drive 4 $\frac{1}{2}$ " shaft centerline (4101 only).

Roller and Rotor Repair Kits

Kit Number	Pump Series	Description	Estimated Weight Ea.
3430-0374	1200	Roller kit includes: 4 Super Rollers, 1 o-ring gasket, and 2 Buna-N seals	3 lbs. 6 oz.
3430-0387	1502C and 1502N	Roller kit includes: 6 Super Rollers, 1 o-ring gasket, and 2 Buna-N seals	1 lb. 7 oz.
3430-0386	1502XL	Roller kit includes: 6 Super Rollers, 1 o-ring gasket, and 2 Viton® seals	1 lb. 8 oz.
3430-0437	1700	Roller kit includes: 5 Super Rollers, 1 o-ring gasket, and 2 Viton® seals	1 lb. 5 oz.
3430-0380	6500	Roller kit includes: 6 Super Rollers, 1 o-ring gasket, and 2 Viton® seals	8 oz.
3430-0381	7560/7700	Roller kit includes: 8 Super Rollers, 1 o-ring gasket, and 2 Viton® seals	12 oz.
3430-0390	4001/4101	Roller kit includes: 4 Super Rollers, 1 o-ring gasket, and 2 Viton® seals	3 oz.

Base Kits

Kit Number	Pump Series	Description	Estimated Weight Ea.
3420-0025	4101	Base kit for mounting to gas engine, 4 $\frac{1}{2}$ " shaft centerline. Base kit includes: 1 Base, 2 Bolts and 2 Lock washers	12 oz.
3420-0024	4001/4101	Base kit for mounting to an electric motor, 3 $\frac{1}{2}$ " shaft centerline. Base kit includes: 1 Base, 2 Bolts and 2 Lock washers	7 oz.
3420-0023	6500	Base kit includes: 1 Base, 2 Bolts and 2 Lock washers	12 oz.
3420-0003	7560	Base kit includes: 1 Base, 3 Bolts and 3 Lock washers	1 lb. 10 oz.
3420-0010	7700/1700	Base kit includes: 1 Base and 4 Bolts	14 oz.
3420-0004	1500	Base kit includes: 1 Base and 4 Bolts	6 lbs.

Roller Pump Repair Tools and Tool Kits

Kit Number	Pump Series	Description
3011-0006	6500	Tool Kit
3011-0021	4001/4101	Tool Kit
3010-0001†	1700, 6500, 7560, 7700	Support fixture
3010-0002†	1700, 6500, 7560, 7700	Support fixture
3010-0003†	4001/4101, 6500	Bearing and seal assembly tool
3010-0004†	4001/4101, 6500	Bearing disassembly tool
3010-0005	1500, 1700, 7560, 7700	Bearing and seal assembly tool
3010-0006	1500, 1700, 7560, 7700	Bearing disassembly tool
3010-0010**	4001/4101, 6500	Bearing support tool
3010-0014**	4001/4101, 6500	Bearing race support tool
3010-0020	1500, 1700, 7560, 7700	Bearing support tool
3010-0066**	1500, 1700, 4001/4101, 6500, 7560, 7700	Wire brush
3010-0067**	1500, 1700, 4001/4101, 6500, 7560, 7700	Wire brush holder
3010-0068**	1500, 1700, 4001/4101, 6500, 7560, 7700	Tool Box
3020-0009**	1500, 1700, 4001/4101, 6500, 7560, 7700	Allen wrench; 1/16" hex

† Included in 3011-0006 - Tool kit for 6500 series roller pumps.

† Included in 3011-0021 - Tool kit for 4001/4101 series roller pumps.

Roller Pump Kits & Accessories

PTO and Shaft Adapters (Female to Female)

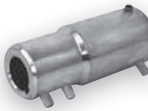

Part Number	PTO (I.D.)	Pump End (I.D.)	Material	RPM	Pump Model
1320-0015	3/4"	5/8"	steel	*	4000, 6500
1320-0016	5/8"	5/8"	steel	*	4000, 6500
1320-0022	1 3/8" (6 spline)	5/8"	die cast	540	6500
1320-0033	1 3/8" (6 spline)	1 5/16"	die cast	540	1500, 1700, 7560, 7700
1320-0038	1 3/8" (21 spline)	1 5/16"	die cast	1000	1500, 1700, 7560
1320-0053	1 3/8" (21 spline)	5/8"	die cast	1000	4000, 6500
1320-0054	3/4"	1 5/16"	die cast	*	1500, 1700, 7560, 7700
1320-0059	1 3/8" (6 spline)	1"	die cast	540	1200/5200
1320-0076	1 3/8" (6 spline)	1 5/16"	forged steel	540	1500, 1700, 7560, 7700
1320-0077	1 3/8" (6 spline)	5/8"	forged steel	540	6500
1320-0078	1 3/8" (21 spline)	1 5/16"	forged steel	1000	1500, 1700, 7560
1320-0079	1 3/8" (21 spline)	5/8"	forged steel	1000	4000, 6500
1320-0080	1 3/4" (20 spline)	1 5/16"	forged steel	1000	1500, 1700, 7560
1320-0081	1 3/8" (6 spline)	1"	forged steel	540	1200/5200

* Refer to recommended pump rpm.

Quick Couplers (Female to Female)



Part Number	PTO (I.D.)	Pump End (I.D.)	Material	RPM	Pump Model
1321-0006	1 3/8" (6 spline)	5/8"	die cast	540	6500
1321-0007	1 3/8" (6 spline)	1 5/16"	die cast	540	1500, 1700, 7560, 7700
1321-0008	1 3/8" (21 spline)	5/8"	die cast	1000	4000, 6500
1321-0009	1 3/8" (21 spline)	1 5/16"	die cast	1000	1500, 1700, 7560
1321-0012	1 3/8" (multi-speed)	5/8"	die cast	540/1000	4000, 6500
1321-0013	1 3/8" (multi-speed)	1 5/16"	die cast	540/1000	1500, 1700, 7560, 7700
1323-0072	1 3/8" (6 spline)	1 5/16"	forged steel	540	1500, 1700, 7560, 7700
1323-0073	1 3/8" (21 spline)	1 5/16"	forged steel	1000	1500, 1700, 7560
1323-0074	1 3/8" (6 spline)	5/8"	forged steel	540	6500
1323-0075	1 3/8" (21 spline)	5/8"	forged steel	1000	4000, 6500
1323-0076	1 3/8" (multi-speed)	1 5/16"	forged steel	540/1000	1500, 1700, 7560, 7700
1323-0077	1 3/8" (multi-speed)	5/8"	forged steel	540/1000	4000, 6500

Speed Controller for Pressure and Output of 12V Motor-Driven Pumps



Part Number	Description	Estimated Weight Each
2530-0057	<ul style="list-style-type: none"> • 12-volt pulse-width modulated motor speed controller • Quick-disconnect motor cables (sheathed) in 20-ft. lengths • 8-foot, 10-gauge power leads with ring terminals • 0-60 psi glycerin-filled gauge • Solenoid/boom circuit <p>Use with 4101N-EH, 4101XL-EH, 4001N-EH and 4001XL-EH 12-volt pumps and eliminate the need for a pressure relief valve in your pumping system. Simply dial your required pressure by adjusting the speed of the motor.</p>	4 lbs. 6 oz.

Other Pump Accessories

Ordering Instructions:

To order one 1/2" x 3/4" Series 2738 coupling, specify the following:
 Note: It is not necessary to order in complete sets, parts can be ordered individually.

Quantity	Part Number	Description
1	2738-1001	1/2" coupling end
1	2738-1003	3/4" coupling end
1	2728-1001	Center disc

Series	Part Number	Description	Estimated Weight Each
2738 (2.0 hp limit)* Replaces L-075	2738-1001	1/2" coupling end, with 1/8" keyway	6 oz.
	2738-1002	5/8" coupling end, with 3/16" keyway	6 oz.
	2738-1003	3/4" coupling end, with 3/16" keyway	6 oz.
	2738-1004	7/8" coupling end, with 3/16" keyway	6 oz.
	2728-1001	Center disc	1 oz.
2739 (5.0 hp limit)* Replaces L-095	2739-1001	5/8" coupling end, with 3/16" keyway	11 oz.
	2739-1002	3/4" coupling end, with 3/16" keyway	11 oz.
	2739-1003	7/8" coupling end, with 3/16" keyway	11 oz.
	2739-1004	15/16" coupling end, with 1/4" keyway	11 oz.
	2739-1005	1" coupling end, with 1/4" keyway	11 oz.
	2739-1006	1 1/8" coupling end, with 1/4" keyway	11 oz.
	2739-1009	24 mm coupling end, with 8mm keyway	11 oz.
	2729-1001	Center disc	1 oz.
	2729-1005	Heavy-duty center disc, urethane material	1 oz.
2741 (10.5 hp limit)* Replaces L-100	2741-1001	3/4" coupling end, with 3/16" keyway	1 lb. 5 oz.
	2741-1004	15/16" coupling end, with 1/4" keyway	1 lb. 5 oz.
	2741-1002	1" coupling end, with 1/4" keyway	1 lb. 5 oz.
	2741-1005	1 1/4" coupling end, with 1/4" keyway	1 lb. 5 oz.
	2741-1007	1 3/8" coupling end, with 5/16" keyway	1 lb. 5 oz.
	2741-1003	1 1/8" coupling end, with 1/4" keyway	1 lb. 5 oz.
	2729-1002	Center disc	1 oz.
	2729-1006	heavy-duty center disc, urethane material	1 oz.
2740 (18.0 hp limit)* Replaces L-110	2740-1001	3/4" coupling end, with 3/16" keyway	3 lbs. 11 oz.
	2740-1002	1" coupling end, with 1/4" keyway	3 lbs. 8 oz.
	2740-1005	1 3/8" coupling end, with 5/16" keyway	3 lbs.
	2740-1007	1 1/8" coupling end, with 1/4" keyway	2 lbs. 15 oz.
	2729-1003	Center disc	3 oz.



* HP limit is electric motor hp at 1725 rpm for driving a steady uniform load. For an uneven load, stop-start and moderate shock loads, divide hp by a 1.5 service factor.

Relief Valves



Part Number	Ports-NPT Inlet (M) Outlet (F)	Max. PSI	Body Material	Valve Material	Estimated Weight Each
3300-0002	1/2" M x 1/2" F	200	cast bronze	stainless steel ball	10 oz.
3300-0001	3/4" M x 3/4" F	400	cast bronze	stainless steel ball	1 lb. 1 oz.
3301-0001	3/4" M x 3/4" F	400	cast bronze	flat neoprene	1 lb. 2 oz.
3300-0093	3/4" M x 3/4" F	300	cast bronze	stainless steel ball	1 lb. 2 oz.
3300-0094	1" M x 3/4" F	150	cast bronze	stainless steel ball	1 lb. 4 oz.
3316-0002	1 1/4"	200	cast iron	stainless steel cone	2 lbs. 14 oz.
3300-0015	3/4" M - 3/4" F	150	nylon	nylon	6 oz.
3300-0016	3/4" M - 3/4" F	250	nylon	nylon	6 oz.
3300-0098	3/4" M - 3/4" F	400	nylon	nylon	6 oz.



Torque Arm Kit (pump not included)

Part Number	Material	RPM	For Pump Series	Estimated Weight Ea.
3430-0540	steel	540/1000	1700, 6500, 7560, 7700 and 9600	2 lbs. 4 oz.